

£399,500  
Leasehold



JS  
JONSIMON  
ESTATE AGENTS

JS  
JONSIMON  
ESTATE AGENTS





### Features

- Deceptively Spacious Four Bedroom Semi-Detached Family Home
- No Onward Chain
- Entrance Porch, Hallway & Downstairs Shower Room
- Spacious Lounge with Feature Fireplace
- Dining Room & Fitted Dining Kitchen
- Four Good Sized Bedrooms
- Three Piece Family Bathroom
- Integral Single Garage with Resin driveway for Several Cars
- Desirable Cul-De-Sac Location in Greenmount Village
- Well Maintained Front & Large Rear Gardens with Patio Area
- Gas Central Heated & Double Glazed Windows
- Viewing is High Recommended and is Strictly By Appointment Only

### Summary of Property

**\*\* WELL PRESENTED FOUR BEDROOM SEMI-DETACHED FAMILY HOME \* SOLD WITH NO CHAIN \*\* SITUATED IS A QUIET & WELL SOUGHT AFTER CUL-DE-SAC LOCATION \*\* A MUST SEE!!!** JonSimon Estate Agents are pleased to present this spacious and ideally located semi-detached family home, situated in a quiet and highly sought-after cul-de-sac within walking distance of Greenmount Cricket Club. The property benefits from gas-fired central heating, double glazing, and is conveniently positioned close to local shops and schools, with easy access to Ramsbottom, Bury town centres, and the motorway network. Offered with vacant possession and no onward chain, this well-proportioned home features bright and generous living space.

The accommodation comprises an entrance porch, a large hallway, a spacious lounge, a separate dining room, and a fitted dining kitchen. Additionally, there is a ground floor shower room with a separate WC. Upstairs, the first floor boasts four good-sized bedrooms and a modern three-piece family bathroom. Outside, the property enjoys a mature, private rear garden with a selection of plants, shrubs, and trees, as well as a resin patio area perfect for outdoor entertaining. To the front, a double resin driveway leads to an integral

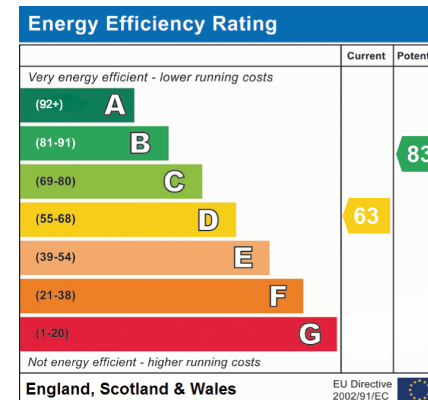

### Local Authority

Bury Council  
Band D  
Tax Band Amount: £2414.58

## Room Descriptions

### Ground Floor

#### Entrance Porch

A composite double glazed front door and windows, tiled flooring and ceiling point.

#### Hallway

UPVC double glazed internal door and windows, laminate flooring, radiator, storage cupboard, ceiling points and stairs leading to the first floor landing.

#### Lounge

UPVC double glazed front window, gas fire with feature surround, radiator, TV point, laminate flooring, wall lights, ceiling coving and ceiling point.

#### Dining Room

UPVC double glazed rear window, radiator, TV point and ceiling point.

#### Dining Kitchen

A range of wall and base units with complementary worksurface, single bowl sink unit with drainer, electric cooker with four ring electric hob, extractor unit above, parts tiled walls, laminate flooring, ceiling point and UPVC double glazed rear window and back door.



Floorplan

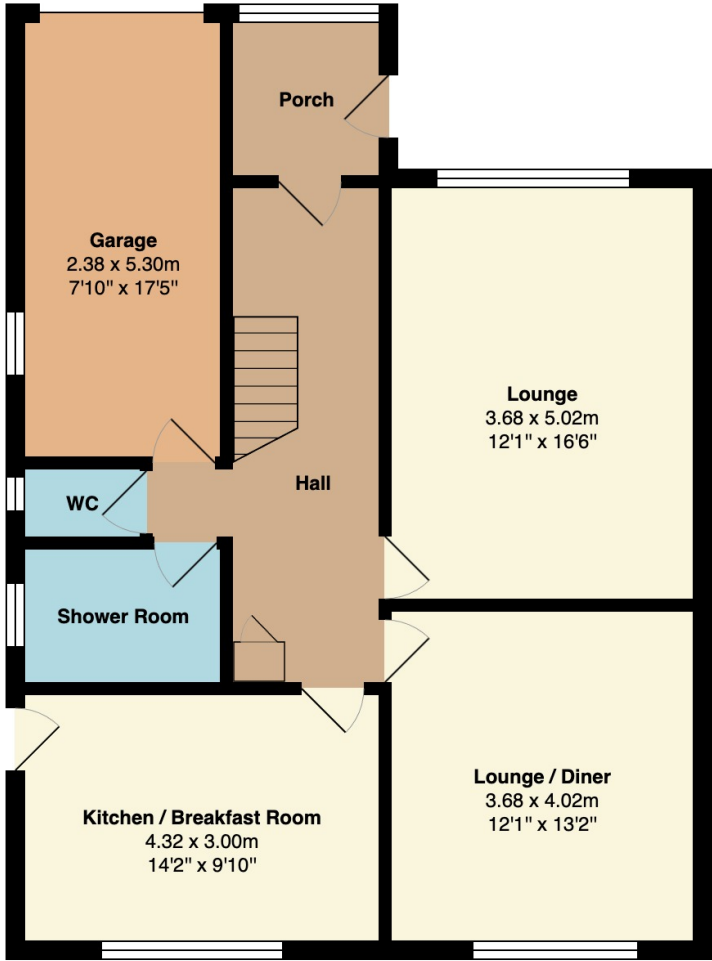

**Ground Floor**  
Area: 83.8 m<sup>2</sup> ... 902 ft<sup>2</sup>

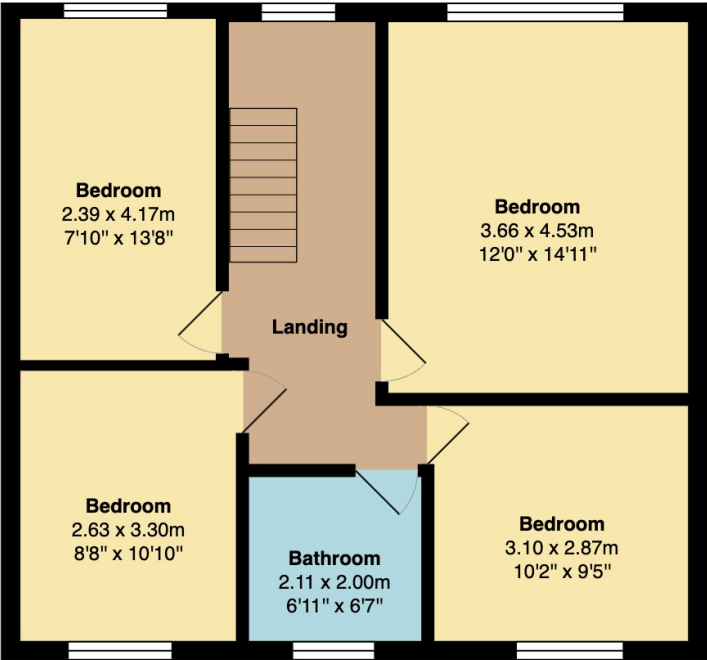

**First Floor**  
Area: 61.9 m<sup>2</sup> ... 666 ft<sup>2</sup>

Total Area: 145.7 m<sup>2</sup> ... 1568 ft<sup>2</sup>

**General Disclaimer**  
Every care has been taken with the preparation of these Sales Particulars but complete accuracy cannot be guaranteed. If there is any point which is of particular importance to you, we will be pleased to check the information for you. These Particulars do not constitute a contract or part of a contract.

**Measurements**  
All measurements quoted are approximate.

**Fixtures, Fittings & Appliances**  
The Fixtures, Fittings & Appliances have not been tested, therefore no guarantee can be given that they are in working order.