



Apartment 3, Deerplay Apartments, Heald Lane, Bacup, Lancashire. OL13 8NZ

- Rent | in advance @ £995
- Deposit | in advance @ £995
- EPC | B
- Council Tax | A



PROPERTY DESCRIPTION

| Modern throughout |

We offer to the market a newly developed apartment situated in the popular, Weir Bacup. With a spacious open plan kitchen and living area, modern fittings and appliances such as a built in fridge freezer, three bedrooms, a modern 4 piece bathroom suite with black fittings throughout.

The property is warmed by gas central heating and fitted with a brand new combination boiler and includes industrial style black column radiators throughout. Located in a peaceful back water position, these apartments provide the perfect home with easy access to local amenities, schools, parks, and popular walking routes.

Rent | in advance @ £995

Deposit | in advance @ £995

Council Tax Band | A

EPC | B



ROOM DESCRIPTIONS



FLOORPLAN & EPC

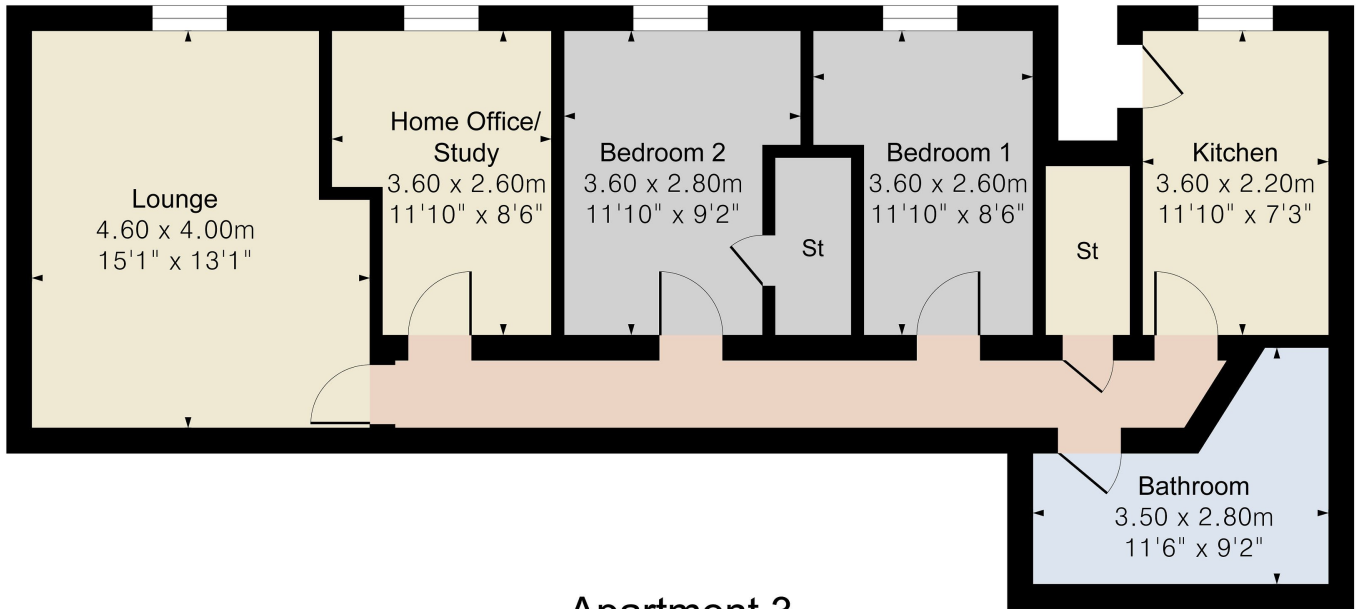

Apartment 3

Approximate Gross Internal Area = 84.00 sq m /904.16 sq ft

This Plan is for layout guidance only. Not drawn to scale unless stated. Windows and door openings are approximate. Whilst every care is taken in the preparation of this plan, please check all dimensions shapes and compass bearings before making any decisions reliant upon them .

Energy Efficiency Rating		Current	Potential
Very energy efficient - lower running costs			
(92+)	A		
(81-91)	B	81	81
(69-80)	C		
(55-68)	D		
(39-54)	E		
(21-38)	F		
(1-20)	G		
Not energy efficient - higher running costs			
England, Scotland & Wales		EU Directive 2002/91/EC	

Burnley
 31, Parker Lane, Burnley, BB11 2BU
 01282 427445
 info@jonsimon.co.uk